



941132-00

Controls for 33/35 Series Rim and Vertical Devices

360L/L-BE/L-DT/T/T-BE

**FOR TRIMS
SHIPPING ON OR
AFTER 4-27-17**

VON DUPRIN®

Installation Instructions

1. Prepare door for exit device. See exit device instructions for locations of holes, backset, line X-X, and center lines.
2. Prepare door for control:
 - A. Transfer line X-X from inside (exit device side) of door to outside (control side) of door. Use extra care if edge of door is beveled. Be sure line X-X is parallel to edge of door.
 - B. Locate and prepare holes as shown on other side.
3. Prepare control:
 - A. If necessary, change handing (360L/L-BE and 360T/T-BE only; 360L-DT handing cannot be changed). For 360T/T-BE, **move mounting studs only** to change handing (see Step No. 4 of "TO CHANGE LEVER HANDING").
 - B. If necessary, set cylinder cam for NL or TL function and install cylinder (360L and 360T only).
 - C. If necessary, adjust tailpiece length (360L/L-BE and 360T/T-BE only).
4. Install exit device and control.

TO CHANGE LEVER HANDING (360L SHOWN; 360L-BE SIMILAR)

1. Remove parts in this order:
 - mounting studs
 - back plate
 - slider
 - retaining ring (use retaining ring pliers)
 - wave spring washer
 - cam

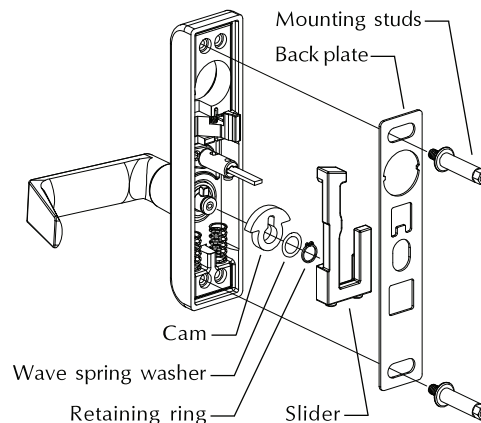

2. Loosen set screw, remove shear pin, rotate lever as shown, install shear pin, tighten set screw.

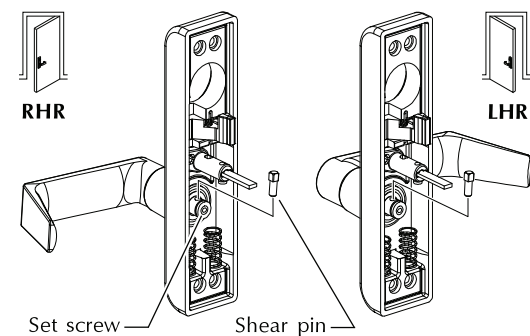

3. Install cam with "R" facing out for RHR or "L" facing out for LHR.

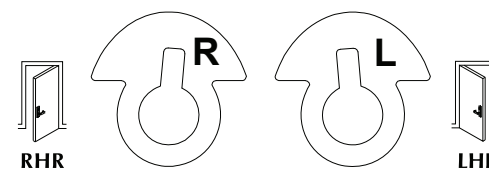

4. Install remaining parts in this order:
 - wave spring washer
 - retaining ring (use retaining ring pliers)
 - slider
 - back plate
 - mounting studs

Mounting studs go in holes that are on same side of control that lever points to.

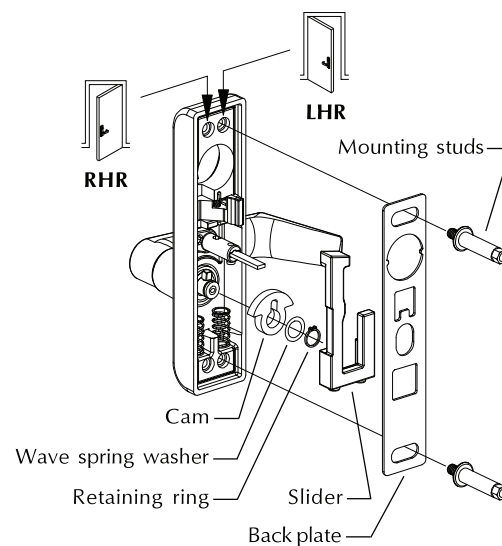

TO SET CAM FOR NL OR TL FUNCTION AND INSTALL MORTISE CYLINDER

Cam must be in position shown **with key removed** for NL or TL function. If necessary, remove cam screws, place cam in correct position, and install cam screws.

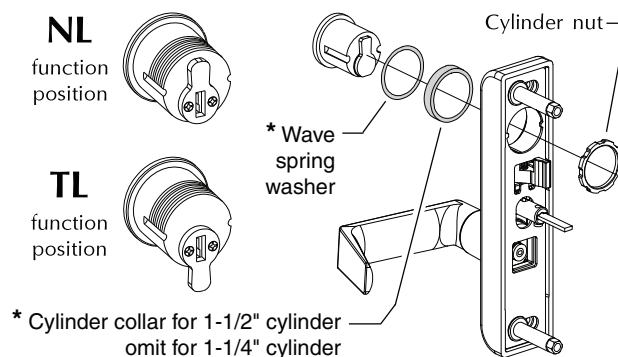

* Would need to be supplied with cylinder

TO ADJUST TAILPIECE LENGTH

Make sure tailpiece is installed at correct length for 1-3/4" thick or 2-1/4" thick door. If necessary, remove pine tree clip, rotate tailpiece, install pine tree clip.

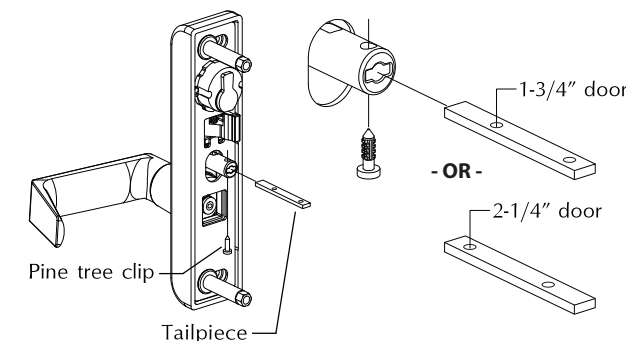

DOOR PREPARATION, METAL DOOR APPLICATION

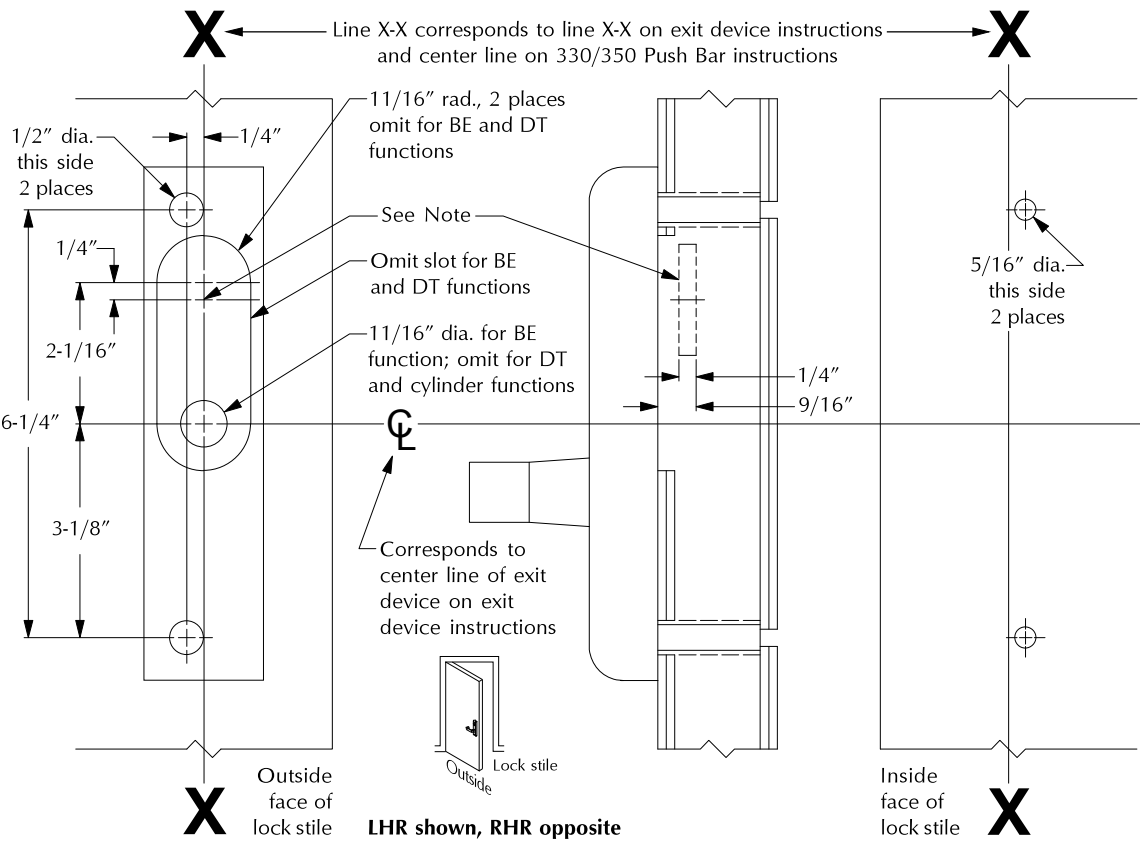

DOOR PREPARATION, WOOD DOOR APPLICATION

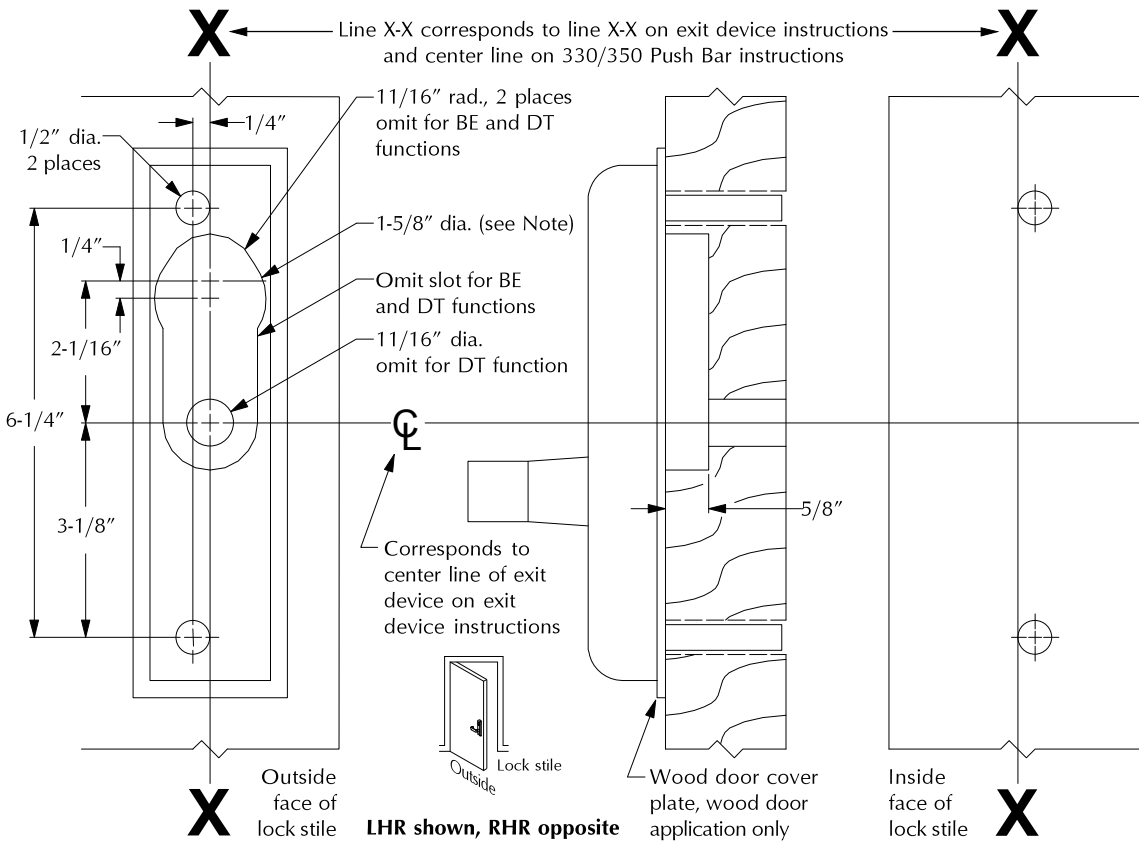

For cutouts on inside face of door, see device instructions

| Device Application Schedule | | | |
|------------------------------|--------|--------|------|
| | L/L-BE | T/T-BE | L-DT |
| 33A/35A Rim | ● | ● | ● |
| 3327A/3527A Vertical Rod | ● | ● | ● |
| 3347A/3547A Vertical Rod | ● | ● | ● |
| 3348A/3548A Vertical Rod | ● | ● | ● |
| 3327A-F/3527A-F Vertical Rod | ● | ● | |
| 3347A-F/3547A-F Vertical Rod | ● | ● | |
| 3348A-F/3548A-F Vertical Rod | ● | ● | |
| 330/350 Push Bar | | | ● |



NOTE

1-5/8" dia. clearance required on internal lock stile features for rotation of mortise cylinder cam in area shown. Omit for BE and DT functions.

Customer Service

1-877-671-7011 www.allegion.com/us



© Allegion 2017
Printed in U.S.A.
941132-00 Rev. 04/17-e