

1200 Series Extra Heavy Duty - 1200-600XHD - Concealed Leaf Hinge

SPECIFICATIONS

Material:	Aluminum 6063-T6
Clearance:	15/32" (12 mm) hinge side plus standard lockside clearance
Fasteners:	<ul style="list-style-type: none"> • Standard: Dril-Kwik® 1/4-20 x 1" Screws • Optional: 1/4-14 x 1-1/2" Wood Screw • Additional options available upon request
Length Options:	Standard and custom lengths available
Door/Frame Reinforcement:	For doors up to 200 lbs. Use 1/8" reinforcement for doors greater than 200 lbs.

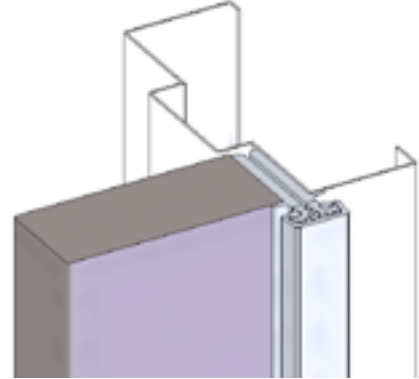

FEATURES

- Strong enough to swing doors heavier than 600 lbs., wider than 4 feet, and taller than 10 feet. Extra heavy duty for heavy, high frequency doors or extremely heavy, low frequency doors; for doors 1-3/4" (45 mm) to 2-3/8" (60 mm) thick.
- Lead lined model for hospital x-ray room doors with double row of screws to straddle lead (Specify "LL")
- Frame and door leaf alignment ribs for proper hinges and door location

Length		XHD Fastener Count	
Inches	Millimeters	# Per Door	# Per Jamb
79	2007	22	22
83	2108	26	26
85	2159	26	26
95	2413	28	28
119	3023	33	33

