

# Standard Duty Commercial Door Closer

DC161 / DC161BF

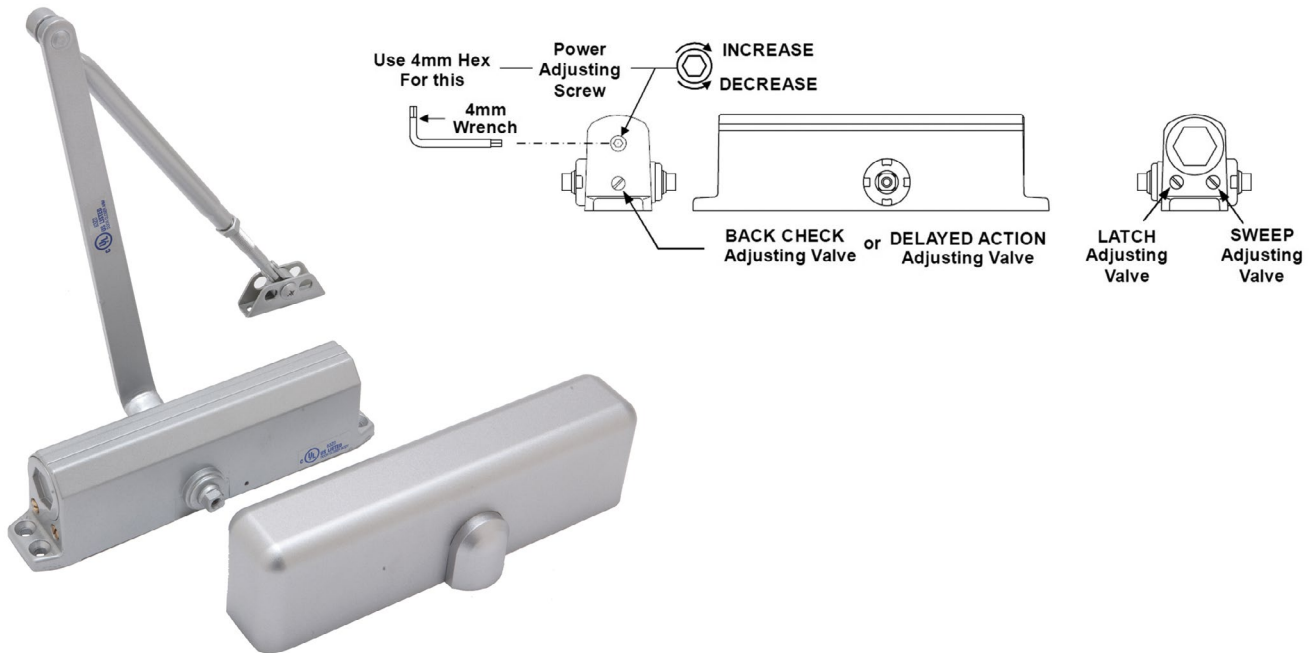

## FEATURES:

- Same hole pattern as Norton 1600
- Tri-pack with regular, parallel and top-jamb mounting, instructions and full size template
- Standard spring adjustment from size 2 to 6
- Non-handed
- Standard with adjustable sweep, latch and back check
- Slimline plastic cover
- SNB - Sex nuts and bolts

## OPTIONS:

- BF: Barrier-free (spring adjustment from size BF-4)
- H: Hold Open Arm

**CAUTION:** Door closer for Low Opening Force Applications: Door closers installed in openings required to meet the requirements of The Americans with Disabilities Act or ANSI/BHMA Standard A117.1, when adjusted to meet those requirements, may not provide adequate closing power to dependably close and latch the door.

## SPECIFICATIONS:

Full rack and pinion type with cast aluminum alloy body. All closers shall be provided with non-critical valves adjustment to independently regulate the sweep, latch and back-check. Closer shall have full spring adjustment from size 1 to size 4 for barrier-free (BF) size, and size 2 to size 6 for standard size. The closer shall be pre-adjusted at the factory to size 2 for the DC161BF and size 3 for DC161. Closer shall be non-handed with slim line cover with a projection of 3" from the surface of the door. All closers shall be mounted to allow the maximum degree of swing.



## CODE COMPLIANCE:

- ANSI A156.4 Grade 1 UL10C and UBC 7.2 for positive pressure
- ANSI A117.1 and ADA for barrier-free accessibility
- C-UBC California Uniform Builders Code - 2001
- California State Fire Marshall (CSFM) approved

## 10 YEAR LIMITED WARRANTY

Item	AL	DU
DC161	•	•
DC161BF	•	•
DC161H	•	•