

A7700 & AF7700 ADA Series

GRADE 1, Rim Type Exit Device



LIFETIME WARRANTY

BHMA CERTIFIED
Be Safe. Be Secure. Look for the Mark.

MEETS The Buy American Act

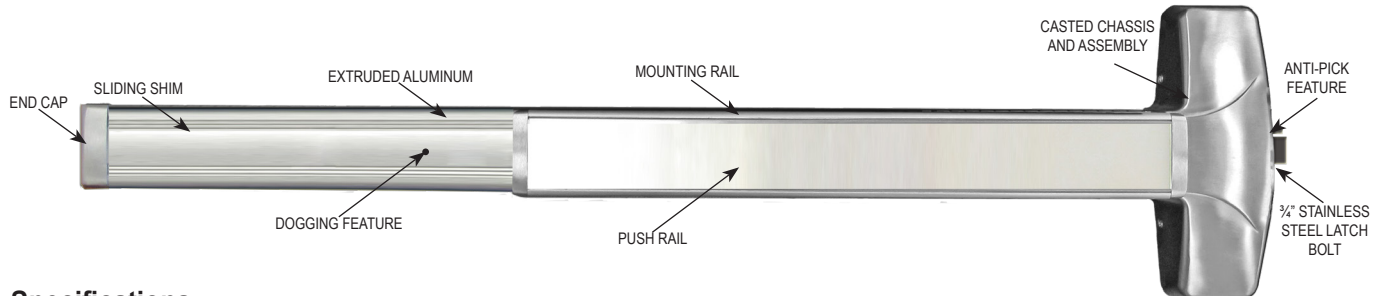

Specifications

For Doors.....	1 3/4" thick standard optional 2 1/4" thick. 4 1/2" minimum stile width for single or double door application using standard 938 strike and pull lever, thumbpiece and escutcheon trims. 2 3/4" backset
Chassis.....	Non-ferrous Alloy (Panic Grade), Steel (Fire Grade)
Cover.....	Non-ferrous plated material. Covers stock hollow metal doors with 161 cut out
Mounting.....	Furnished with wood and machine screws. Available thru-bolts on request. Thru-bolts are included and standard packaging on fire rated devices
End Cap.....	Brass, Bronze or Stainless Steel construction
Alarm.....	Available. Prefix "NALRM" before MODEL #
Hand.....	Non-handed, center hub for 2 3/4" backset
Latch Bolt.....	Stainless Steel 3/4" throw with anti-pick feature
Spring.....	Stainless Steel throughout
ANSI Standard.....	A156.3, Grade 1
Rail Assembly.....	Heavy gauge extruded aluminum body with Stainless Steel push pad
Strike.....	938 packed standard (See strike page)
Dogging Feature.....	Allen-type key furnished standard on non-fire labeled devices
Mullion.....	Available
UL and ULC Listed.....	A7700 Series for panic. AF7700 Series for fire exit hardware for all types of 4' x 8' single doors and 8' x 8' double doors for up to 3 hour fire labeled installations. Conforms to standards UL10C and UBC 7-2-1997 codes
Finish.....	Architectural plated finishes
Electronic Functions.....	(ELR) Electrical Latch Retraction and RX & LX Signal Switch available
Anti-Microbial Coating.....	Available on US32D only. Use part # ANT-B-EXIT



***Americans with Disability Act (ADA) compliant
5 lbs opening force on ADA Series only**

***Refer to the Price List for Stock Sizes and Finishes**

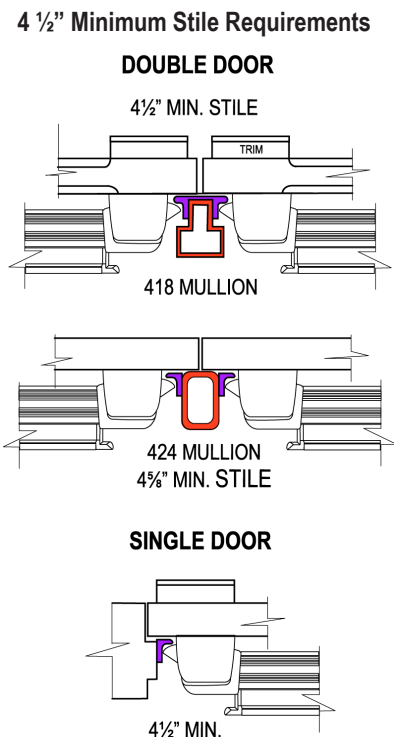

DIMENSIONS

Touchbar height to finished floor	41" (1041 mm) at center		
Touchbar projection			
Neutral	3 5/8" (92 mm)		
Depressed	2 7/8" (73 mm)		
Center case	8 1/16" x 2 3/4" x 2 1/2" (205 mm x 70 mm x 63 mm)		
MODEL	ACTUAL LENGTH	MAX CUT DOWN	DOOR SIZE
A7700EO36, AF7700EO36	32"	6"	30" to 36" door width
A7720EO48, AF7720EO48	44"	10"	38" to 48" door width

A7760V & AF7760V ADA Series

GRADE 1, Vertical Rod Type Exit Device



LIFETIME WARRANTY

BHMA CERTIFIED
Be Safe. Be Secure. Look for the Mark.

MEETS
The Buy American Act



Specifications

- For Doors.....** 1 3/4" thick standard optional 2 1/4" thick. 3 3/4" minimum stile width required for single door application. 3 1/2" minimum stile width required for double door application. Lever, thumb piece and escutcheon trims available. 2 3/4" backset
- Top & Bottom Chassis.....** Non-ferrous Alloy (Panic Grade), Steel (Fire Grade)
- Cover.....** Non-ferrous plated material. Covers stock hollow metal doors with 161 cut out.
- Mounting.....** Furnished with wood and machine screws. **Thru-bolts are included and standard packaging on fire rated devices.**
- End Cap.....** Brass, Bronze or Stainless Steel construction
- Alarm.....** Available. Prefix "NALRM" before MODEL #
- Hand.....** Handed. Easily field reversible. Specify at time of order LHR, RHR for convenience

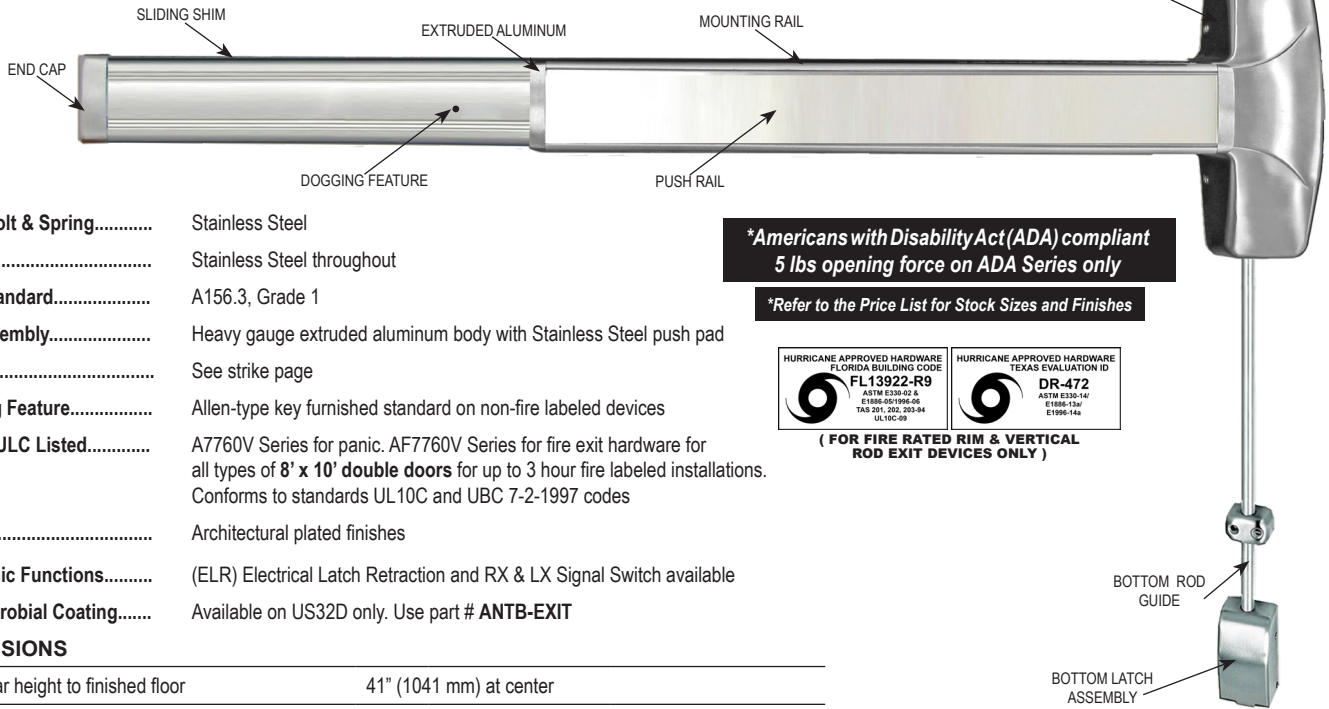

- Latch Bolt & Spring.....** Stainless Steel
- Spring.....** Stainless Steel throughout
- ANSI Standard.....** A156.3, Grade 1
- Rail Assembly.....** Heavy gauge extruded aluminum body with Stainless Steel push pad
- Strike.....** See strike page
- Dogging Feature.....** Allen-type key furnished standard on non-fire labeled devices
- UL and ULC Listed.....** A7760V Series for panic. AF7760V Series for fire exit hardware for all types of 8' x 10' double doors for up to 3 hour fire labeled installations. Conforms to standards UL10C and UBC 7-2-1997 codes
- Finish.....** Architectural plated finishes
- Electronic Functions.....** (ELR) Electrical Latch Retraction and RX & LX Signal Switch available
- Anti-Microbial Coating.....** Available on US32D only. Use part # ANT-B-EXIT

***Americans with Disability Act (ADA) compliant
5 lbs opening force on ADA Series only**

***Refer to the Price List for Stock Sizes and Finishes**



(FOR FIRE RATED RIM & VERTICAL ROD EXIT DEVICES ONLY)

DIMENSIONS

Touch bar height to finished floor	41" (1041 mm) at center
Touch bar projection	
Neutral	3 5/8" (92 mm)
Depressed	2 7/8" (73 mm)
Center case	8 1/16" x 2 3/4" x 2 1/2" (205 mm x 68 mm x 62 mm)
Panic grade top & bottom latch case	3 15/16" x 2 1/8" x 1 3/8" (100 mm x 52 mm x 42 mm)
Fire grade top latch case	3 15/16" x 2 9/16" x 2 1/16" (100 mm x 68 mm x 53 mm)
Fire grade bottom latch case	3 15/16" x 2 1/8" x 1 3/8" (100 mm x 52 mm x 42 mm)
Top and bottom rod length for 36" x 84" doors	Top rod 37 1/2" (955 mm), bottom rod 35 5/8" (905 mm)
Top and bottom rod length for 48" x 96" doors	Top rod 49 5/8" (1260 mm), bottom rod 35 5/8" (905 mm)
Vertical Rods	1/2" (13 mm) Round tubing

MINIMUM STILE REQUIREMENTS

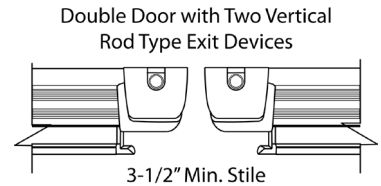

MODEL	ACTUAL SIZE	MAXIMUM CUT DOWN	DOOR SIZE
A7760V3684, AF7760V3684, A7790V3696, AF7790V3696, A7750V36120, AF7750V36120	32"	6"	30" to 36" door width
A7780V4896, AF7780V4896, A7740V48120, AF7740V48120	44"	10"	38" to 48" door width

ALBR7760V & ALBRF7760V ADA Series

GRADE 1, Vertical Rod Exit Device Less Bottom Rod



LIFETIME WARRANTY

BHMA CERTIFIED
Be Safe. Be Secure. Look for the Mark.

MEETS The Buy American Act



Specifications

For Doors.....	1 3/4" thick standard optional 2 1/4" thick. 3 3/4" minimum stile width required for single door application. 3 1/2" minimum stile width required for double door application. Lever, thumb piece and escutcheon trims available. 2 3/4" backset
Top Chassis.....	Non-ferrous Alloy (Panic Grade), Steel (Fire Grade)
Cover.....	Non-ferrous plated material. Covers stock hollow metal doors with 161 cut out
Mounting.....	Furnished with wood and machine screws. Thru-bolts are included and standard packaging on fire rated devices
End Cap.....	Brass, Bronze or Stainless Steel construction
Alarm.....	Available. Prefix "NALRM" before MODEL #

Hand.....	Handed. Easily field reversible. Specify at time of order LHR, RHR for convenience
Latch Bolt & Spring.....	Stainless Steel
Spring.....	Stainless Steel throughout
ANSI Standard.....	A156.3, Grade 1
Rail Assembly.....	Heavy gauge extruded aluminum body with Stainless Steel push pad
Strike.....	See strike page
Dogging Feature.....	Allen-type key furnished standard on non-fire labeled devices
UL and ULC Listed.....	A7760V Series for panic. AF7760V Series for fire exit hardware for all types of 8' x 8' double doors for up to 3 hour fire labeled installations. Conforms to standards UL10C and UBC 7-2-1997 codes
Finish.....	Architectural plated finishes
Electronic Functions.....	(ELR) Electrical Latch Retraction and RX & LX Signal Switch available
Anti-Microbial Coating.....	Available on US32D only. Use part # ANTB-EXIT

***Americans with Disability Act (ADA) compliant
5 lbs opening force on ADA Series only**

***Refer to the Price List for Stock Sizes and Finishes**

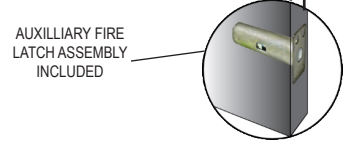
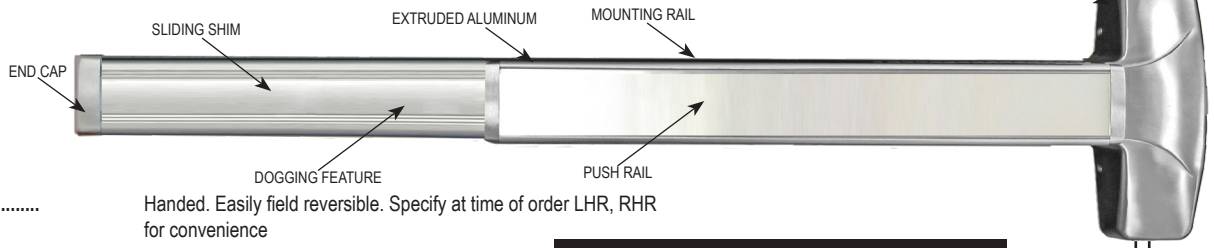

DIMENSIONS

Touch bar height to finished floor	41" (1041 mm) at center
Touch bar projection	
Neutral	3 5/8" (92 mm)
Depressed	2 7/8" (73 mm)
Center case	8 1/16" x 2 3/4" x 2 1/2" (205 mm x 68 mm x 62 mm)
Panic grade top & bottom latch case	3 15/16" x 2 1/8" x 1 3/8" (100 mm x 52 mm x 42 mm)
Fire grade top latch case	3 15/16" x 2 9/16" x 2 1/16" (100 mm x 68 mm x 53 mm)
Fire grade bottom latch case	3 15/16" x 2 1/8" x 1 3/8" (100 mm x 52 mm x 42 mm)
Top rod length for 36" x 84" doors	Top rod 37 1/2" (955 mm)
Top rod length for 48" x 96" doors	Top rod 49 5/8" (1260 mm)
Vertical Rods	1/2" (13 mm) Round tubing

MINIMUM STILE REQUIREMENTS

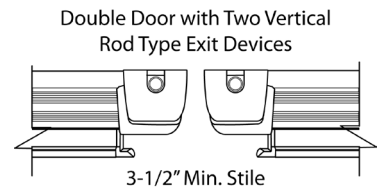

MODEL	ACTUAL SIZE	MAXIMUM CUT DOWN	DOOR SIZE
ALBR7760V3684, ALBRF7760V3684, ALBR7790V3696, ALBRF7790V3696, ALBR7750V36120	32"	6"	30" to 36" door width
ALBR7780V4896, ALBRF7780V4896, ALBR7740V48120	44"	10"	38" to 48" door width

N-77CVR & N-F77CVR Series

Optional Less Bottom Rod (LBR)

Grade 1 Concealed Vertical Rod Exit Device for Wood & Metal Doors



***Americans with Disability Act (ADA) compliant - 5 lbs opening force**

***Refer to the Price List for Stock Sizes and Finishes**

Specifications

LBR (Optional)	No bottom strike. Free access for wheel chairs, stretchers and carts which eliminates tripping potential and disfiguration of floors due to dragging of bottom bolts.
For Doors	Wood or Metal. 1 3/4" (44.5 mm) minimum thickness 4 1/2" (114 mm) minimum stile width
Top & Bottom Chassis	Steel Material
Chassis Cover	Zinc Material
Mounting	Furnished standard with wood and machine screws
End Cap	Stainless Steel Construction
Hand	Handed. Easily field reversible. Specify at time of order LHR or RHR for convenience
ANSI Standard	A156.3, Grade 1
Strikes	N-260 & N-265 (Steel), 233 (Stainless Steel)
Fire Exit Hardware	N-F77CVR Series for fire exit hardware for all types of 8' x 10' double doors, LBR Series for fire exit hardware for all types of 8' x 10' double doors for up to 3 hour fire labeled installations. Conforms to standards UL10C and UBC 7-2-1997 codes
Rail Height	Specify door opening and mounting height of center line of rail when ordering a Vertical Rod Exit Device 41" from floor
Trim	See Trim Designs section
Electronic Functions	(ELR) Electrical Latch Retraction and RX & LX Signal Switch available
Alarm	Prefix "NALRM" before PART #
Dogging Feature	Cylinder dogging available for non-rated applications
Anti-Microbial Coating	Available on US32D only. Use part # ANTB-EXIT

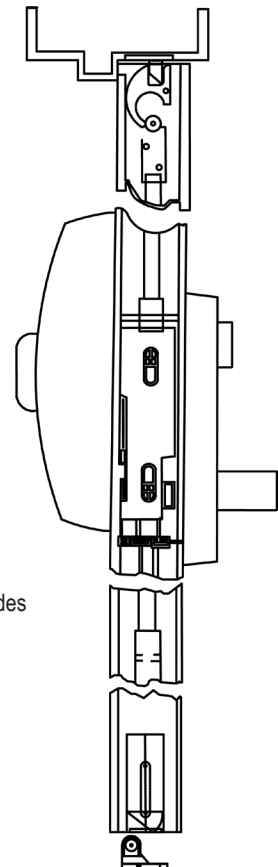

MODEL SIZE	ACTUAL LENGTH	MAX CUT DOWN	DOOR SIZE
N-77CVR3684, N-F77CVR3684, N-77CVR3696, N-F77CVR3696, N-77CVR36120, N-F77CVR36120	32"	6"	30" to 36" door width
N-77CVR4896, N-F77CVR4896, N-77CVR48120, N-F77CVR48120	44"	10"	36" to 48" door width

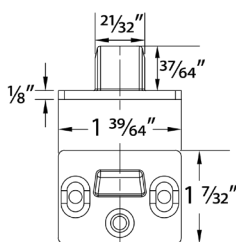

N-260 TOP STRIKE
 • Surface Mount
 • Steel Material

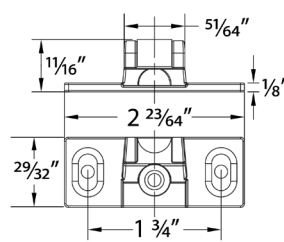

N-265 BOTTOM STRIKE
 • Surface Mount
 • Steel Material

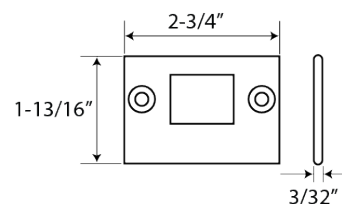

233 BOTTOM STRIKE
 • Flush Mounting Stainless Steel
 • Furnished with expansion shields
 • Mortised into floor

N-MR7700 & N-FMR7700 Series



GRADE 1 Mortise Lock Exit Device

LIFETIME WARRANTY

BHMA
CERTIFIED
Be Safe. Be Secure. Look for the Mark.

MEETS
The Buy American Act

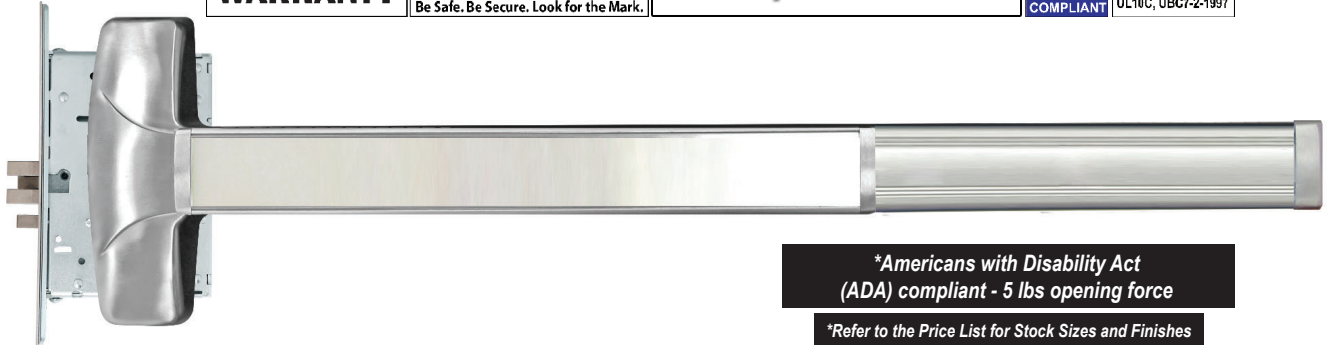

***Americans with Disability Act (ADA) compliant - 5 lbs opening force**
***Refer to the Price List for Stock Sizes and Finishes**

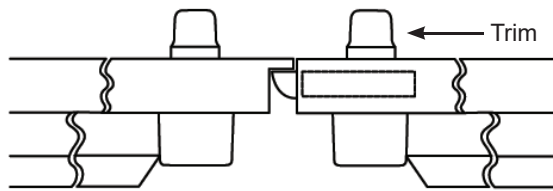

Pair of Doors

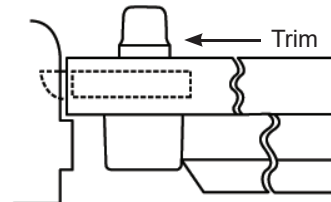

Single Doors

Specifications

- For Doors..... Wood / Metal 1 3/4" (44.5 mm) minimum thickness
4 1/2" (114 mm) minimum stile width
- Mortise Lock Case..... Steel
- Head Chassis..... Aluminum
- Chassis Cover..... Zinc Material
- Mounting..... Furnished standard with wood and machine screws
- End Cap..... Aluminum
- Handing..... Handed. Easily Field Reversible.
Specify RHR or LHR for convenience
- ANSI Standard..... A156.3, Grade 1
- Strikes..... Standard ANSI Strike (Stainless Steel)
- Fire Exit Hardware..... N-FMR7700 Series for fire exit hardware for all types of 8' x 8' double doors for up to 3 hour fire labeled installations. Conforms to standards UL10C and UBC 7-2-1997 codes.
- Mortise Lock..... Grade (1) for 1 3/4" (44.5mm) thick doors. Handed, Field Reversible. Specify RHR or LHR. Fits door prepared for ANSI Standard A115.1
- Trim..... See Trim Designs section
- Electronic Functions..... (ELR) Electrical Latch Retraction and RX & LX Signal Switch available
- Alarm..... Prefix "NALRM" before PART #
- Dogging Feature..... Cylinder dogging available for non-fire rated applications
- Anti-Microbial Coating..... Available on US32D only. Use part # ANTB-EXIT

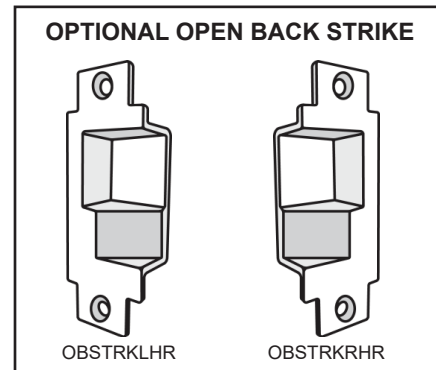

MODEL SIZE	ACTUAL LENGTH	MAX CUT DOWN	DOOR SIZE
N-MR7700EO36, N-FMR7700EO36 N-MR7705EO36, N-FMR7705EO36	32"	6"	30" to 36" door width
N-MR7700EO48, N-FMR7700EO48 N-MR7705EO48, N-FMR7705EO48	44"	12"	36" to 48" door width

N-GLS7700 & N-FGLS7700 Series

GRADE 1 Rim Type Narrow Stile Exit Device



Specifications

For Doors	Wood, Metal or Aluminum Glass doors with 1 3/4" minimum stile width, 1 3/4" thickness for single or double door application
Chassis	Steel Material
Chassis Cover	Zinc Material
Mounting	Furnished standard with wood and machine screws. Thru-bolts available upon request.
End Cap	Aluminum Material
Alarm	Available for 36" bar only. Use PART# N48ALRM77
Hand	Non-Handed
Latch Bolt	Stainless Steel, 3/4" throw
Spring	Steel Material
ANSI Standard	A156.3, Grade 1
Rail Assembly	Aluminum Material
Strike	246 (Copper), Optional 247 Strike (Copper)
Dogging Feature	Allen-type key furnished standard. Cylinder Dogging kit available for 36" bar only. Use PART# 48CD7700
Mullion	Available
UL and ULC Listed	N-GLS7700 Series for Panic & Safety, N-FGLS7700 Series for Fire Exit hardware for all types of 4' x 8' single doors and 8' x 10' double doors for up to 3 hour fire labeled installations. Conforms to ANSI/UL 10C, ANSI/UL 305 standards.
Electronic Functions	ELR (Electrified Latch Retraction) available for both 36" and 48" push bar. DE (Delayed Egress) available for 36" bar only. Use PART# DEKIT48
Anti-Microbial Coating	Available on US32D only. Use part # ANTB-EXIT

**Americans with Disability Act (ADA) compliant
5 lbs opening force*

**Refer to the Price List for Stock Sizes and Finishes*

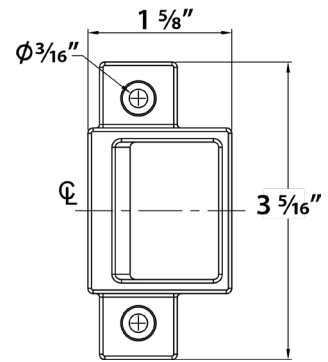

246 STRIKE

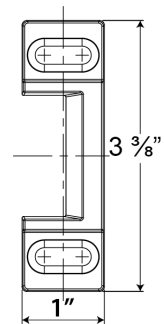

247 STRIKE (OPTIONAL)

DIMENSIONS

Push rail height to finished floor	41" (1041 mm) at center
Push rail projection	
Neutral	3 5/8" (92 mm)
Depressed	2 7/8" (73 mm)
Center case	8" x 3" x 2 5/8" (203 mm x 76 mm x 60 mm)

MODEL	ACTUAL SIZE	MAXIMUM CUT DOWN	DOOR SIZE
N-GLS7700EO36, N-FGLS7700EO36	35"	10"	26" to 36" door width
N-GLS7700EO48, N-FGLS7700EO48	46 3/4"	13"	35" to 48" door width

NOTES:

- N-GLS7700 & N-FGLS7700 Exit Devices are intended for use with Narrow Stile applications
- If used for Regular Door/Frames, must cut down device to size, and follow installation for regular door/frame applications.

N-77GLS-CVR & N-F77GLS-CVR Series



GRADE 1 Concealed Vertical Type, Narrow Stile Exit Device
Optional Less Bottom Rod (LBR)



Specifications

For Doors	Wood, Metal or Aluminum Glass doors with 1 3/4" minimum stile width, 1 1/4" thickness for single or double door application
Top & Bottom Chassis	Steel Material
Chassis Cover	Zinc Material
Mounting	Furnished standard with wood and machine screws
End Cap	Aluminum Material
Alarm	Available for 36" bar only. Use PART# N48ALRM77

***Americans with Disability Act (ADA) compliant**
5 lbs opening force on ADA Series only

***Refer to the Price List for Stock Sizes and Finishes**

Hand	Handed. Easily field reversible. Specify at time of order LHR or RHR for convenience
ANSI Standard	A156.3, Grade 1
Rail Assembly	Aluminum Material
Strike	N-260 & N-265 (Steel), 233 (Stainless Steel); Optional N-221 Bottom Strike (Brass)
Dogging Feature	Allen-type key furnished standard. Cylinder Dogging kit available for 36" bar only. Use PART# 48CD7700
UL and ULC Listed	N-77GLS-CVR Series for Panic & Safety, N-F77GLS-CVR Series for Fire Exit hardware for all types of 4' x 8' single doors and 8' x 10' double doors for up to 3 hour fire labeled installations. Conforms to ANSI/UL 10C, ANSI/UL 305 standards.
Electronic Functions.....	ELR (Electrified Latch Retraction) available for both 36" and 48" push bar. DE (Delayed Egress) available for 36" bar only. Use PART# DEKIT48
Anti-Microbial Coating.....	Available on US32D only. Use part # ANTB-EXIT

DIMENSIONS

Push rail height to finished floor	41" (1041 mm) at center
Push rail projection	
Neutral	3 5/8" (92 mm)
Depressed	2 7/8" (73 mm)
Center case	8" x 3" x 2 3/8" (203 mm x 76 mm x 60 mm)
Top and bottom rod length for 36" x 84" doors	Top rod 37" (940 mm), bottom rod 34" (864 mm)
Top and bottom rod length for 48" x 96" doors	Top rod 48 1/8" (1241 mm), bottom rod 34" (864 mm)
Vertical Rods	3/8" (10 mm)

NOTES:

- N-77GLS-CVR & N-F77GLS-CVR Exit Devices are intended for use with **Narrow Stile** applications
- If used for Regular Door/Frames, must cut down device to size, **use flange brackets (to be considered fire rated)**, and follow installation for regular door/frame applications.
- Auxiliary Fire Latch is standard for both fire rated N-F77GLS-CVR & N-LBRF77GLS-CVR Exit Devices

MODEL	ACTUAL SIZE	MAXIMUM CUT DOWN	DOOR SIZE
N-77GLS-CVR-3684, N-F77GLS-CVR-3684	35"	10"	26" to 36" door width
N-77GLS-CVR-4896, N-F77GLS-CVR-4896	46 3/4"	13"	35" to 48" door width

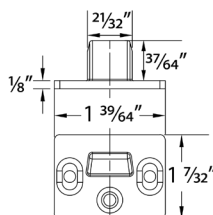

N-260 TOP STRIKE

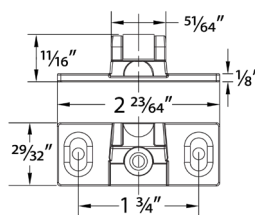

N-265 BOTTOM STRIKE

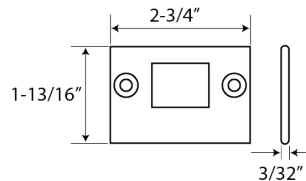

233 BOTTOM STRIKE

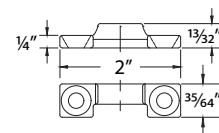

N-221 BOTTOM STRIKE

77GLS-SVR & F77GLS-SVR Series



GRADE 1 Surface Vertical Type, Narrow Stile Exit Device Optional Less Bottom Rod (LBR)



Specifications

For Doors	Wood, Metal or Aluminum Glass doors with 1 3/4" minimum stile width
Top & Bottom Chassis	Steel Material
Chassis Cover	Zinc Material
Mounting	Furnished standard with wood and machine screws
End Cap	Aluminum Material

***Americans with Disability Act (ADA) compliant
5 lbs opening force**

***Refer to the Price List for Stock Sizes and Finishes**

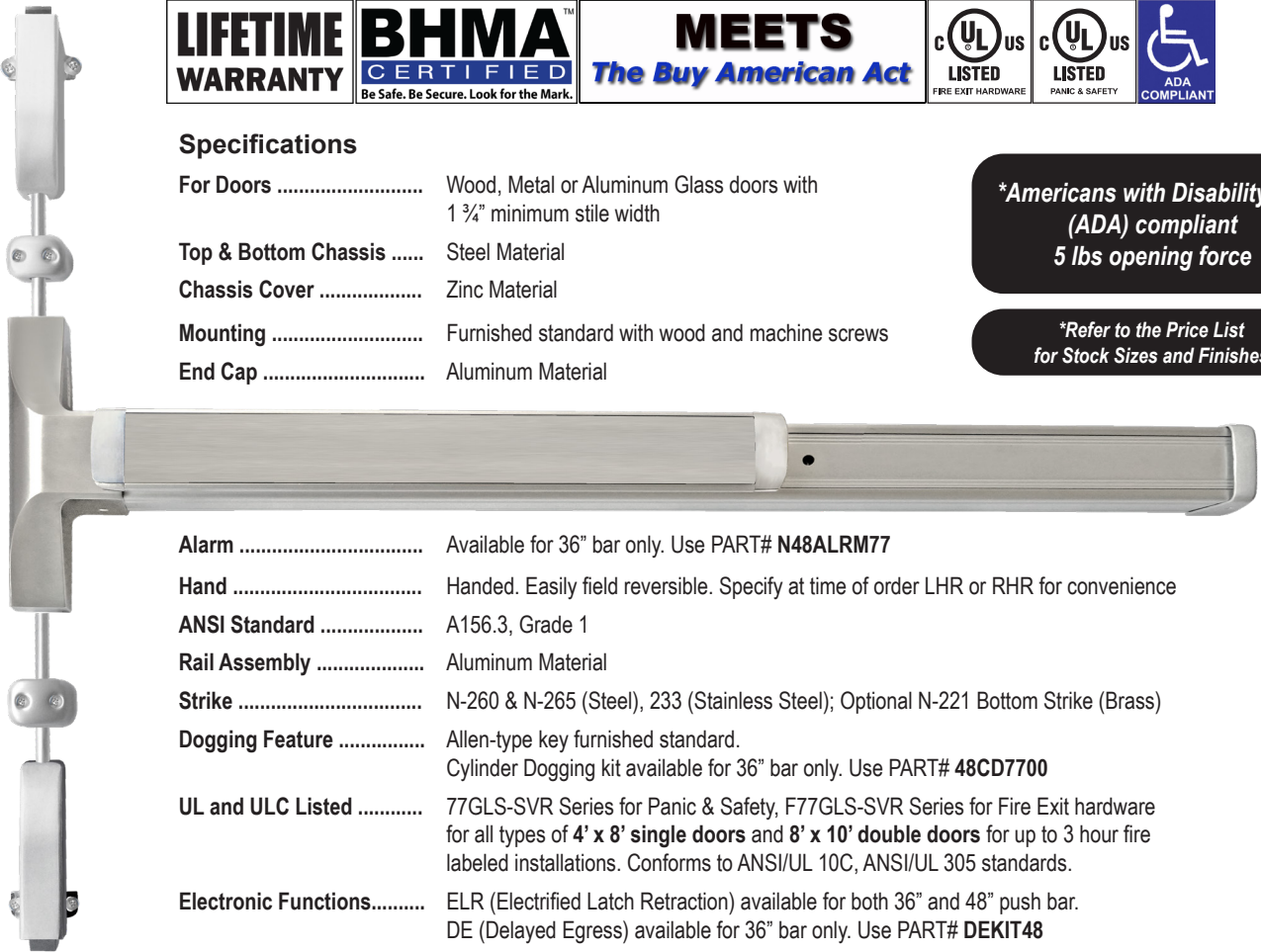

Alarm	Available for 36" bar only. Use PART# N48ALRM77
Hand	Handed. Easily field reversible. Specify at time of order LHR or RHR for convenience
ANSI Standard	A156.3, Grade 1
Rail Assembly	Aluminum Material
Strike	N-260 & N-265 (Steel), 233 (Stainless Steel); Optional N-221 Bottom Strike (Brass)
Dogging Feature	Allen-type key furnished standard. Cylinder Dogging kit available for 36" bar only. Use PART# 48CD7700
UL and ULC Listed	77GLS-SVR Series for Panic & Safety, F77GLS-SVR Series for Fire Exit hardware for all types of 4' x 8' single doors and 8' x 10' double doors for up to 3 hour fire labeled installations. Conforms to ANSI/UL 10C, ANSI/UL 305 standards.
Electronic Functions.....	ELR (Electrified Latch Retraction) available for both 36" and 48" push bar. DE (Delayed Egress) available for 36" bar only. Use PART# DEKIT48
Anti-Microbial Coating.....	Available on US32D only. Use part # ANTB-EXIT

DIMENSIONS

Push rail height to finished floor	41" (1041 mm) at center
Push rail projection	
Neutral	3 5/8" (92 mm)
Depressed	2 7/8" (73 mm)
Center case	8" x 3" x 2 3/8" (203 mm x 76 mm x 60 mm)
Panic and Fire grade top & bottom latch case	4 11/16" x 1 7/8" x 1 1/8" (119 mm x 47 mm x 28 mm)
Top and bottom rod length for 36" x 84" doors	Top rod 35 1/4" (895 mm), bottom rod 34 1/4" (870 mm)
Top and bottom rod length for 48" x 96" doors	Top rod 47 1/4" (1200 mm), bottom rod 34 1/4" (870 mm)
Vertical Rods	1/2" (13mm)

NOTES:

- 77GLS-SVR & N-F77GLS-SVR Exit Devices are intended for use with Narrow Stile applications
- If used for Regular Door/Frames, must cut down device to size, and follow installation for regular door/frame applications.
- Auxiliary Fire Latch is standard for both fire rated F77GLS-SVR & LBRF77GLS-SVR Exit Devices

MODEL	ACTUAL SIZE	MAXIMUM CUT DOWN	DOOR SIZE
77GLS-SVR-3684, F77GLS-SVR-3684	35"	10"	26" to 36" door width
77GLS-SVR-4896, F77GLS-SVR-4896	46 3/4"	13"	35" to 48" door width

