



3D ROUTING JIG



Routing Instructions

Read All Instructions Before Beginning

The **3D Routing Jig** is designed to route wooden doors and frames, ensuring a perfect fit for the 3D Concealed hinges. This routing guide is used for both:

- 3D Concealed Hydraulic Hinge
- 3D Concealed Free Swing Hinge

Routing Dimensions

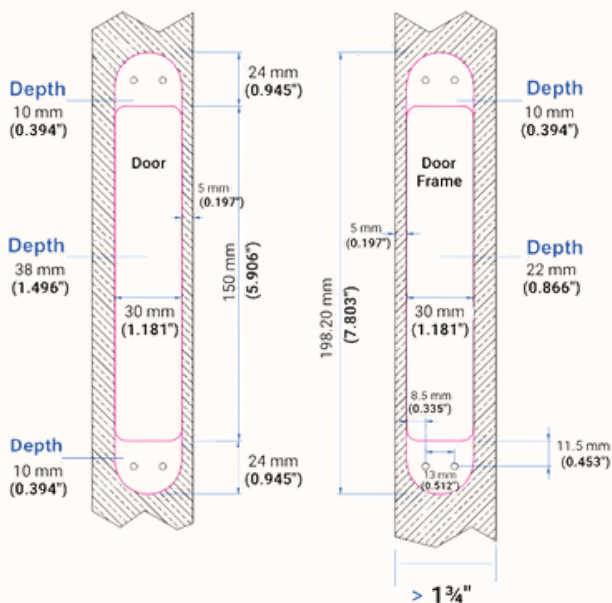

Routing Video/Tutorial



ALREX USA, LLC

417 E. Second St, Rochester, MI 48307

(248) 617-4851

support@alrexusa.com

www.alrexusa.com

Routing Instructions

The routing size/width/depth is different between the Door and Door Frame.

Step 1:

1. First determine your desired hinge location.
2. Screw down the routing jig in your desired location.

Note: The top of the routing jig (when flush against the wood) lays 14 mm (0.551") above the wood, prior to any routing.

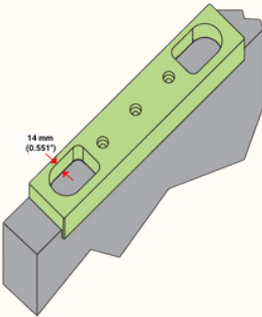

Step 2:

1. Route out both routing jig holes: **10 mm (0.394")**
 - a. Please route the 10 mm depth in at least two (2) separate passes of (maximum) **5 mm (0.197")** per pass.

Note: Route 10 mm holes for both the door and door frame.

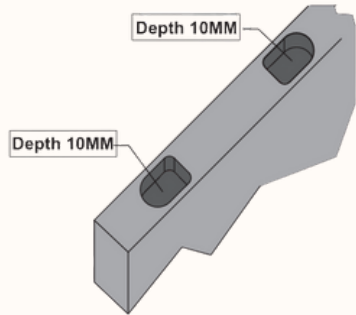

Step 3:

1. Remove the initial routing jig and lay the second routing jig into place.
 - a. The second routing jig has slots that will fit perfectly into the previously routed-out holes.
2. Screw the second routing jig into place.

Note: The second routing jig's body should lay flush against the wood, with the bottom slots fitting perfectly into the previously routed-out holes.

Note: With the second routing jig laying flush against the wood, the top of the routing jig lays 14 mm (0.551") above the wood.

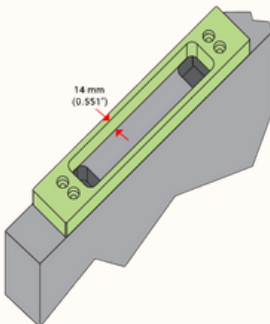

Step 4:

1. Door Routing

- a. Route out routing jig hole: **38 mm (1.299")**
 - i. Please route the 38 mm depth in at least eight (8) separate passes of (maximum) **5 mm (0.197")** per pass.

2. Frame Routing

- a. Route out routing jig hole: **22 mm (1.299")**
 - i. Please route the 22 mm depth in at least five (5) separate passes of (maximum) **5 mm (0.197")** per pass.

