

Standard Hollow Metal Door Hinge Location Chart (1 3/4" Doors)

TRUDOOR
 (623) 748-9122
 www.trudoor.com

Measure from the top of the door, to the top of each hinge cut-out

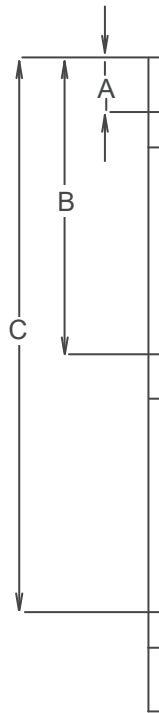

Standard Weight .134
 4 1/2" Hinges

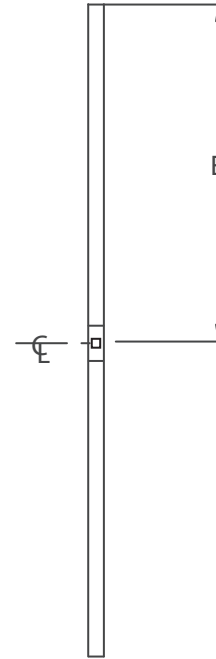

Measure from the top of the door, to the center-line of the lock cut-out

Note:
 8'0" doors have a 4th hinge;
 bottom hinge = D
 (not shown in drawing)

	6'8"				7'0"				8'0"				
MANUFACTURER	A	B	C	E	A	B	C	E	A	B	C	D	E
AMWELD	7 3/8"	37 5/16"	67 1/4"	39 9/16"	7 3/8"	39 5/16"	71 1/4"	43 9/16"	7 3/8"	32 11/16"	58"	83 5/16"	55 9/16"
CECO	6 5/8"	37 5/8"	68 5/8"	38 1/16"	6 5/8"	39 5/8"	72 5/8"	42 1/16"	6 5/8"	32 5/8"	58 5/8"	84 5/8"	54 1/16"
CURRIES	4 7/8"	35 1/8"	65 3/8"	39 7/8"	4 7/8"	37 1/8"	69 3/8"	43 7/8"	4 7/8"	30 3/8"	55 7/8"	81 3/8"	55 7/8"
DKS	7 3/8"	37 5/16"	67 1/4"	39 9/16"	7 3/8"	39 5/16"	71 1/4"	43 9/16"	7 3/8"	32 11/16"	58"	83 5/16"	55 9/16"
FENESTRA	5 1/8"	35 1/8"	65 1/8"	39 9/16"	5 1/8"	37 1/8"	69 1/8"	43 9/16"	5 1/8"	30 1/2"	55 13/16"	81 1/8"	55 9/16"
KEWANEE	7 1/4"	37 5/16"	67 3/8"	39 9/16"	7 1/4"	39 5/16"	71 3/8"	43 9/16"	7 1/4"	32 5/8"	58"	83 3/8"	55 9/16"
MESKER	4 7/8"	35 1/8"	65 3/8"	39 9/16"	4 7/8"	37 1/8"	69 3/8"	43 9/16"	4 7/8"	30 3/8"	55 7/8"	81 3/8"	55 9/16"
PIONEER	4 7/8"	35 1/8"	65 3/8"	41 7/8"	4 7/8"	37 1/8"	69 3/8"	45 7/8"	4 7/8"	30 3/8"	55 7/8"	81 3/8"	57 7/8"
REPUBLIC	7 3/8"	37 5/16"	67 1/4"	39 9/16"	9 3/8"	39 5/16"	69 1/4"	43 9/16"	4 7/8"	30 3/8"	55 7/8"	81 3/8"	55 9/16"
STEELCRAFT	7 3/8"	37 5/16"	67 1/4"	39 9/16"	7 3/8"	39 5/16"	71 1/4"	43 9/16"	7 3/8"	32 21/32"	57 15/16"	83 1/4"	55 9/16"

Standard undercut on all doors is 3/4", with the exception of Curries and Pioneer, which is 5/8"