

HOW TO INSTALL THIS CYLINDRICAL KNOBSET

This knobset fits 1-3/8" ~2" thick doors
Backset 2-3/4" standard or 2-3/8" optional

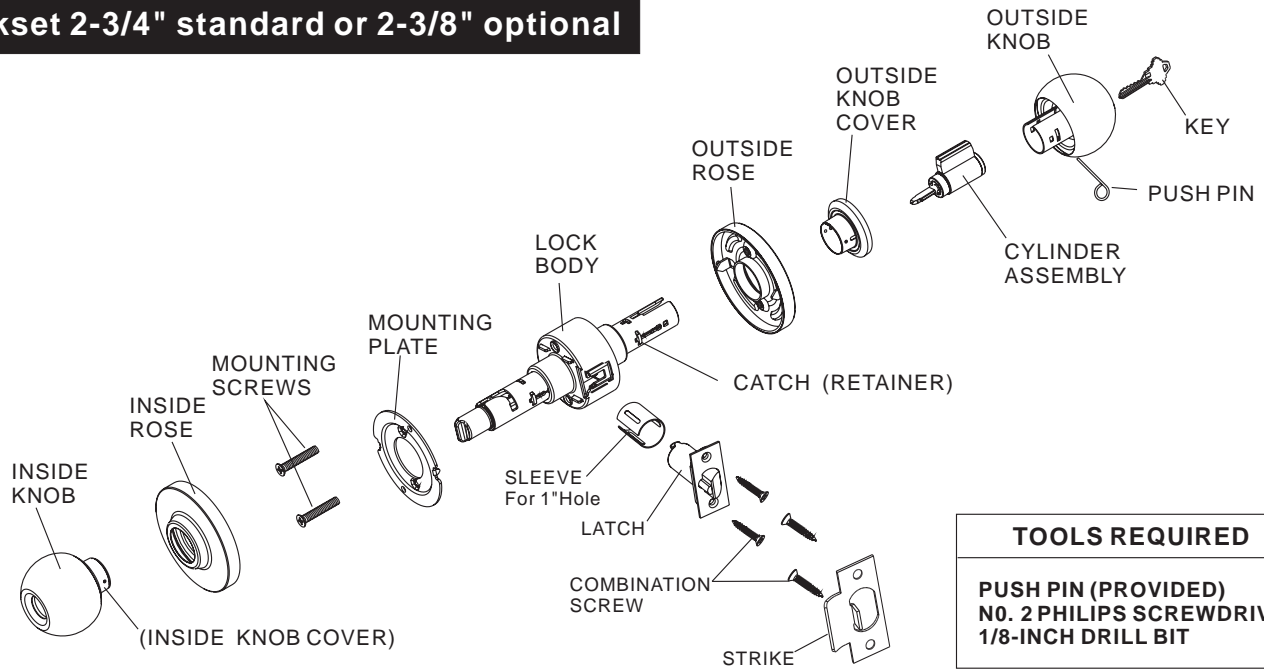

TOOLS REQUIRED

PUSH PIN (PROVIDED)
NO. 2 PHILIPS SCREWDRIVER
1/8-INCH DRILL BIT

1 NEW DOOR PREPARATION

1. Fold template over edge of door and mark holes.
2. Drill 2-1/8" hole through face of door (from both sides to avoid damaging door).
3. Drill a 1" hole in edge of door.
4. Cut 5/32" notches on 2-1/8" hole on both sides of door.
5. Mortise latch unit front 2-1/4" x 1-1/8" x 1/8"

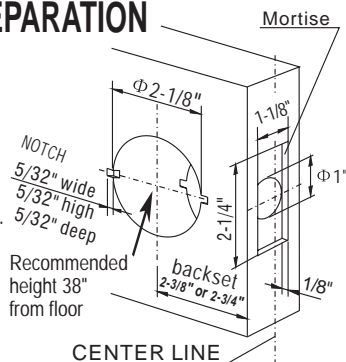

2 REMOVE INSIDE TRIM AND ADJUST DOOR THICKNESS

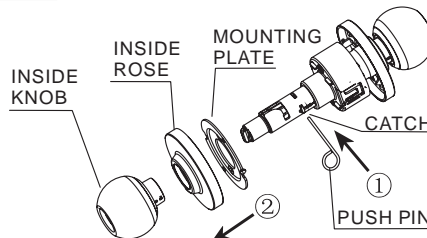

2A: Use push pin to depress knob catch and pull off inside knob, then remove inside rose, mounting plate.

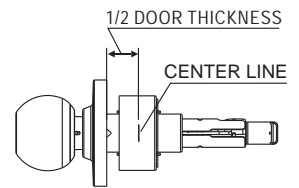

2B: Turn outside rose to adjust center line of lock body to match the centerline of the door.

3 INSTALL LOCK BODY

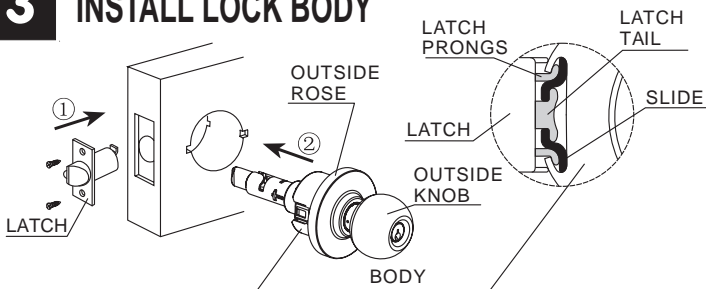

3A: Install latch and secure with screws provided.

3B: Slide lock body into door and make sure that latch prongs engage lock body.

CHANGING DIRECTION OF KEYWAY

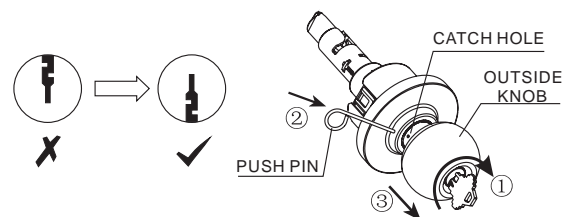

Keyway direction is normally in down position
To change the direction, follow steps below:

(for more details, see reverse page)

1. Turn key 75° clockwise, insert push pin into catch hole to depress knob catch. Pull outside knob off of spindle.
2. Turn knob 180° and then reinstall knob.

4 INSTALL INSIDE KNOB

- Install mounting plate and secure with mounting screws.
- Screw inside rose onto spindle until hand tight.
- Push inside knob all the way onto spindle until it clicks into catch hole.

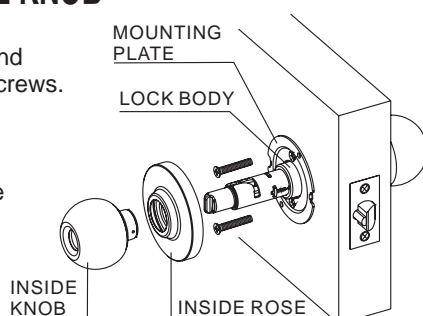

5 INSTALL STRIKE

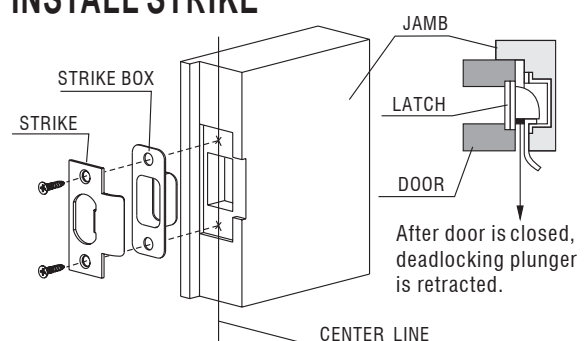

Cylinder replacement or rekeying

A HOW TO REMOVE A KNOB FROM A LOCK

These skills are efficacious for removing a knob or lever. It is easy to remove a knob or lever from spindle.

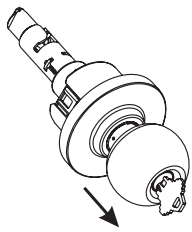

A1: Pull knob / lever forcibly, to force catch leans on side of catch hole.

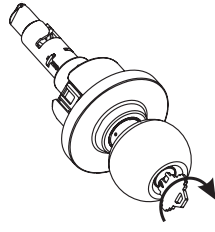

A2: Turn key clockwise to the end and keep it on end position.

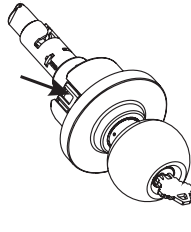

A3: Press slider with left thumb or other tool and keep press, then release your right hand from key.

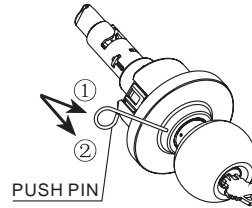

A4: Depress catch ① and prize forward ②, to force catch moves backward and keep it depressed by the throat of the knob. You may need to pull knob again and redo steps A1-A4 until catch is depressed by the throat of the knob.

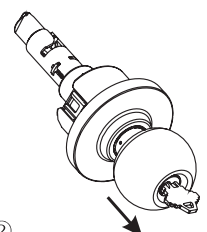

A5: Now release your hand, just pull knob out off spindle.

B HOW TO REMOVE KNOB CAP

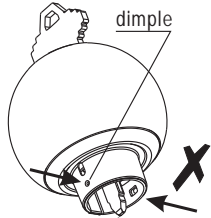

B1: Do not nip dimple, otherwise the more forcibly you nip, the more tightly the dimple snaps on the knob.

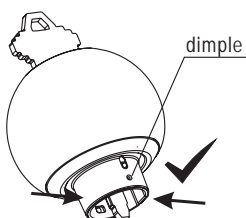

B2: Nip this side, force dimples open and pull knob cap. It is easy to remove knob cap this way.

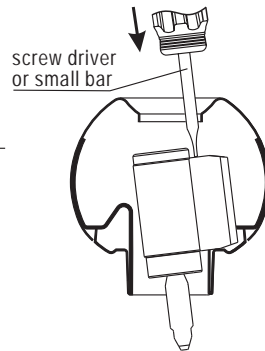

B3: Or you can knock the cylinder with a screw driver to push knob cap out as shown. It is easy to remove knob cap this way.

C HOW TO INSTALL A KNOB

Our lock has a special design, **spring back inner spindle**, it is for easy installing cylinder. So the way of installing a cylinder is a little different. Please follow steps below.

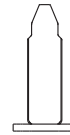

C0: If you change a new cylinder, please reuse our tailpiece in the new cylinder, it is specially designed for our lock for easy installation.

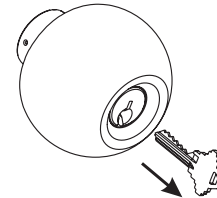

C1: After changing a new cylinder, pull out the key to confirm the key and keyway direction are correct.

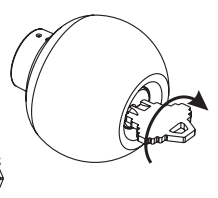

C2: Insert key and turn key 90 degrees clockwise.

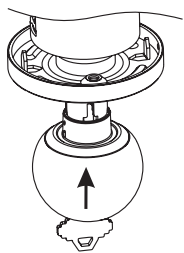

C3: Erect the lock, hold key and put knob onto spindle, you may need to shake the key slightly to lead knob gets in easily.

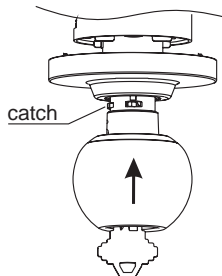

C4: Put in knob until knob is stopped by the catch.

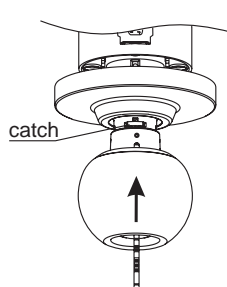

C5: Depress catch and push knob in.

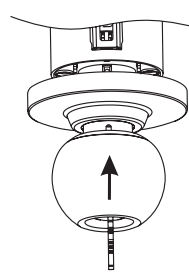

C6: Push knob into position and pull knob to make sure catch fully engages knob.

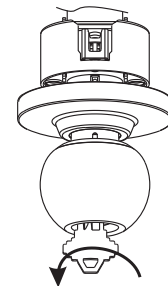

C7: Turn key back counter clockwise. Not that if you turn key in wrong direction, you can not pull key out. In this case, you need to remove the knob and reinstall it (see A1-A5 and redo these steps).

This lock has a special design, **spring back inner spindle**, when you turn back the key, cylinder tailpiece will automatically engage into inner spindle with a click, and you can retract slider by key now.

D ABOUT our new feature SPRING BACK INNER SPINDLE

Spring back inner spindle design, this design makes cylinder installing very easy. You only need to turn key 90 degrees before put in a knob, then put in knob into position and turn back key. That is ok. This design frees your hand from complex action.

Of course you can still install cylinder with traditional method. That is, put in knob to catch, turn key and retract slider, depress catch, then push in knob to end. This procedure is complex and needs more skill.

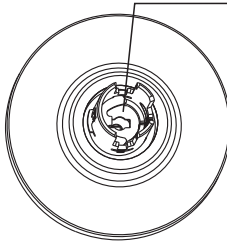

This tailpiece spacer can be pushed down and springs back itself.

Please push and test tailpiece spacer with a "cross head" screw driver, you will understand how it works, and understand its advantage.

TROUBLESHOOTING

When you do cylinder replacement, sometimes you will find the tailpiece spacer is snapped on mid way, it does not spring back, especially when you are not so skilled for this job. Do not worry about this, you can use a pencil **with flat end** to push (knock) tail piece spacer to full end, the spring back function will recover.

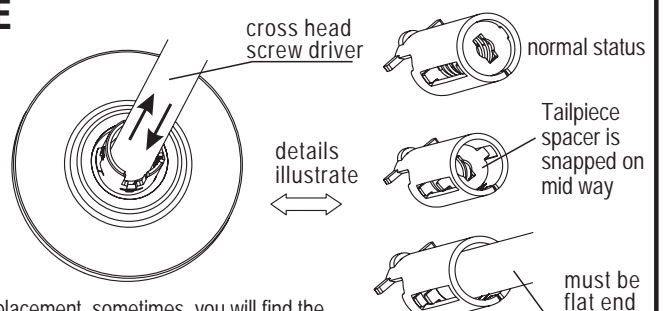

Push (knock) to full end with a **flat end pencil**, then the spring back function will recover.